



WEST  
MIDLANDS  
INTERCHANGE

M6/JCT.12

# COMMUNITY LIAISON GROUP

9 July 2024

**OXFORD**  
AN OIVERS COMPANY

 **LOGISTICS  
CAPITAL PARTNERS**

# AGENDA

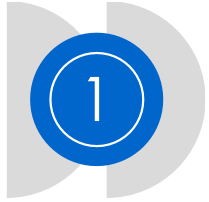

Construction  
update



Highways update



Planning update



Social value  
update



Community  
fund update



Community  
parks update  
and update  
from  
Wildwood UK



Construction update

# Construction update

## CURRENT WORKS – PHASE 1

- Earthworks, drainage and pond construction to 50 series, 20 series and partial earthworks to 3010
- Hard landscaping to community parks on Croft Lane and Calf Heath
- Property demolition
- Ecological mitigation

## PROGRESS

### 50 series plots:

- Remediation of earthworks following winter conditions
- Drainage and pond construction ongoing
- Discharge water off site via the canal

### 20 series:

- A5 Temporary Access

### 3010:

- Works ongoing to complete plateaus with import of material from 50 series

### Utilities:

- NGED installed 2No. New pylons for upcoming 132kV diversion
- Vicarage Road Access



# Construction update

## UPCOMING WORKS

### 50 Series:

- Continuation and completion of Earthworks, plus Drainage to 50 series
- Earthworks retaining walls and screening bunds
- Hard landscaping to Calf Heath Community Park
- Hedge Trans locations – Autumn/Winter 24
- Vicarage Road Plant crossing

### 40 Series:

- Dewatering of existing surface water
- Plot Earthworks

### 30 Series:

- Dewatering of existing surface water
- Plot Earthworks

### 20 Series:

- 11kv electricity diversions

### Highways/Other:

- Drainage installation across Vicarage Road and Straight Mile
- Gravelly Way plant crossing
- A449 Laybys
- Site wide tree and hedge clearances ongoing following bird nesting season
- Q4 agricultural bridge demolition over West Coast Main Line

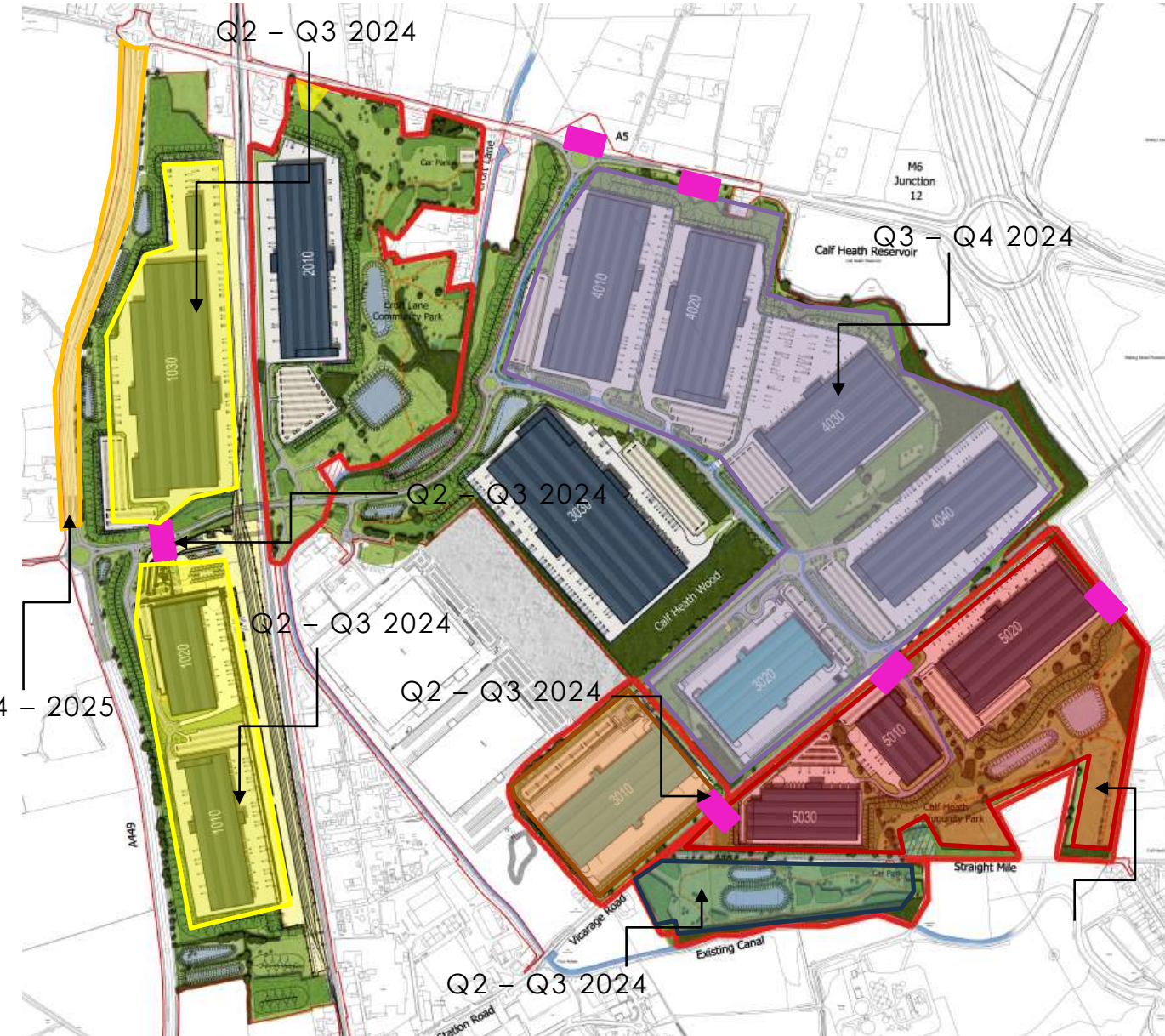



# Highways update

# A449 Laybys



Construction Start - Q3/Q4 2024

- Duration - 30 weeks
- Traffic Management - 24/7 Lane Closures with a 40mph temporary speed limit
- Full Overnight Closures 20:00hrs to 06:00hrs (when required)

	DOO BOUNDARY
	PROPOSED HIGHWAY BOUNDARY
	EXISTING HIGHWAY BOUNDARY TO BE RETAINED
	PROPOSED CARRIAGEWAY
	PROPOSED SHARED USE FACILITY
	PROPOSED EARTHWORK
	PROPOSED VERGE
	PROPOSED ISLAND
	EXISTING CARRIAGEWAY
	EXISTING ISLAND
	BUFT COLOUR TACTILE
	PROPOSED BUSH
	PROPOSED CLUSTER HAZARD MARKER POST
	PROPOSED HAZARD MARKER POST
	PROPOSED DRAINAGE HEADMILL

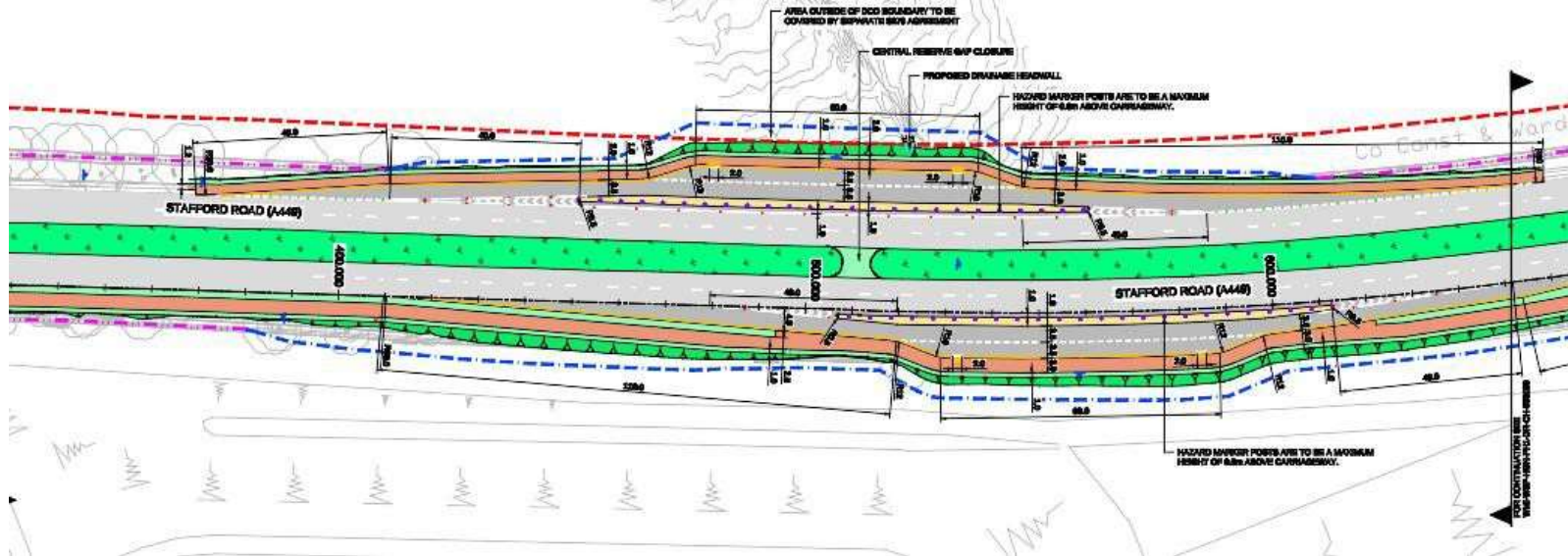

# Vicarage Road Plant Crossing

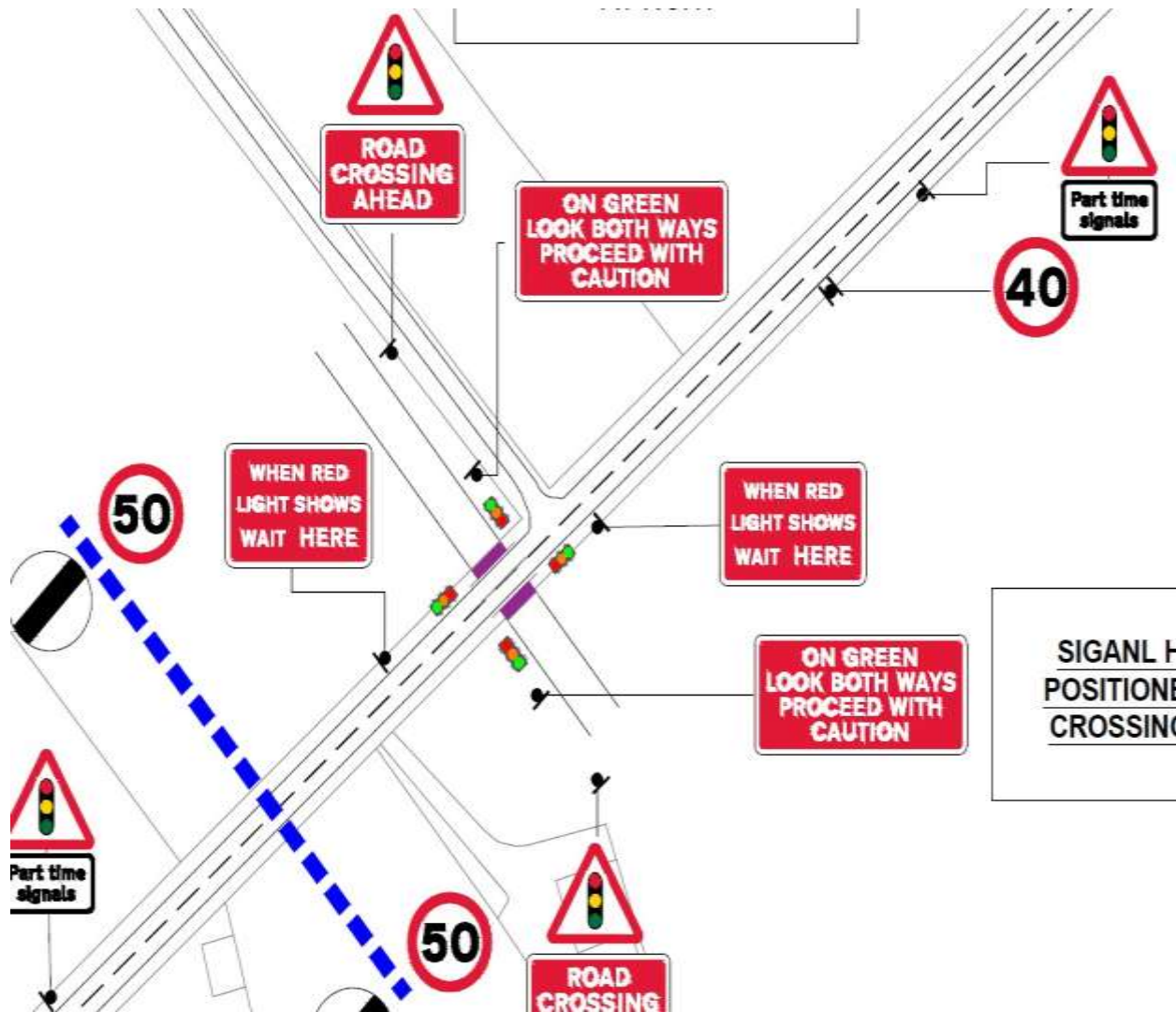

- **Construction Start:** Q2/3 24
- **Duration:** 24 weeks
- **Traffic Management:**
  - 2-way traffic signals.
  - 40mph temporary speed limit during its operation.
  - Part time signal lights to be turned off at night.







Planning update

# Planning update

---

## Recently decided applications

- Re-Discharge of Catchments D and E Surface Water Drainage Scheme
- Updated Phase 4 DCEMP (with Vicarage Road Welfare Facility and south pylon tower construction access)
- Updated DCTMP and construction traffic routing
- Variation to Phasing of A5 Roundabout
- Agricultural Bridge Demolition
- North pylon temporary access
- Changes to tree and hedgerow removals in Phases 2A and 4

# Planning update

---

## Submitted Applications Awaiting Decision

- A449 Laybys
- Rail terminal office and driver welfare facility planning application
- Re-Discharge of Phases 2A and 4 Earthworks (including details of paths through the community parks)
- Fencing to the east side of the WCML
- Rail Freight Terminal (pre-application submission)
- Estate Management Office (pre-application submission)

# Planning update

---

## Main Upcoming Submissions

- Rail Freight Terminal
- Estate Management Office
- Western section of the new Link Road, including the bridge complex
- Re-Discharge of Phases 2B and 3 Earthworks and Catchments A and B Surface Water Drainage Scheme
- New HV Substation
- Phase 1 Green Infrastructure, including the Community Parks



Social value update

# Social Value - Jobs & Employment

## DELIVERED

- **Apprenticeships** - 162 weeks
- **Training opportunities** - 19 weeks
- **Work experience** - 14 weeks
- **Local Employment** - 9 FTE (102 employees within 30 miles)
- **Volunteering** – 250 hours (including educational engagement and career support)



## Update from the last quarter:

- Further T-level placements for 3 students - NSCG and Walsall College.
- 3 weeks work experience for 2 students on site - South Staffordshire College and Staffordshire University Academy
- Employment and Skills Partnership meeting
- Careers fairs, insight days and mock interviews supported.

## Social Value - STEM

- **13 Curriculum Engagement Activities**
- **Over 170 hours of support provided**

**Variety of activities undertaken including employer talks, insight sessions, careers fairs, book donations and hosting t-level placements.**

### **14 Schools / Colleges engaged:**

- South Staffordshire College
- The Rural Enterprise Academy
- Codsall Community High School
- Cannock Chase High School
- St Mary's Catholic Primary School
- St Pauls CofE First School
- St Mary & St Chads CofE
- Norton Canes High School
- University of Wolverhampton
- Staffordshire University
- Stafford College (NSCG)
- Walsall College
- Walton High School
- Pool Hayes Academy



# Social Value - STEM

## Schools approached:

- Wolgarston High School – Liaising on engagement
  - Cheslyn Hay Academy – Liaising on engagement
  - Princefield First School
  - Brewood Middle School
  - Penkridge Middle School
  - Cardinal Griffin Catholic College
  - Staffordshire University Academy
  - Marshbrook First School
  - St Johns CE First School
  - St Johns Primary Academy
- Also working with Staffordshire and Stoke Careers and Enterprise Company – offering:
- Workplace visits
  - Careers Lead / Teacher encounter sessions
- Looking at opportunities for home educated and care leavers.

## Planned activity:

- Careers Lead encounter – November
- Enrichment Programme – September / October
- South Staffordshire College – Employer talks – September and October
- Codsall Community High College – Employer Network
- University of Wolverhampton – site visit - Autumn





# In the community

## UPDATE

- **Volunteering - 179 hours**
  - [Greensforge Sailing Club](#) - painting, gutters, jetty
  - [Kingswood Trust](#) - Upskilling on the new Mindfulness Garden
  - Schools - Careers Fairs, Employer Talks, Insight Days



## STAY UP TO DATE

- **Facebook** - follow / like the West Midlands Interchange - WMI page
- **Newsletter** - Subscribe by emailing [contactus@communityrelations.co.uk](mailto:contactus@communityrelations.co.uk)



West Midlands Interchange - WMI



Community fund update

# Community fund update

5



## Community Fund - [£65k fund](#)

- Applications being approved by South Staffs District Council
- Sailing Club approved for motor for safety boat and revamp of clubhouse kitchen

## Successful bid applications

- **Greensforge Sailing Club** - motor for safety boat and revamp of clubhouse kitchen
- **Shareshill Parish Council and Hatherton Parish Council** – village boundary white gates
- **Calf Heath Village Hall Trustees** – contribution to toilet refurb and improved green space
- **Lapley, Stretton & Wheaton Aston Parish Council** – community bench
- **Cross Britain Way Walk** – contribution to updating rights of way and reprints



Community parks update

# Creating inspiring places for Nature, Play and Learning

We design and build wild natural play areas,  
restore nature and bring the wonder of our past  
to life.

[Enquire](#)

[Learn more](#)



# Some of our projects



# Designs for Calf Heath Community Park

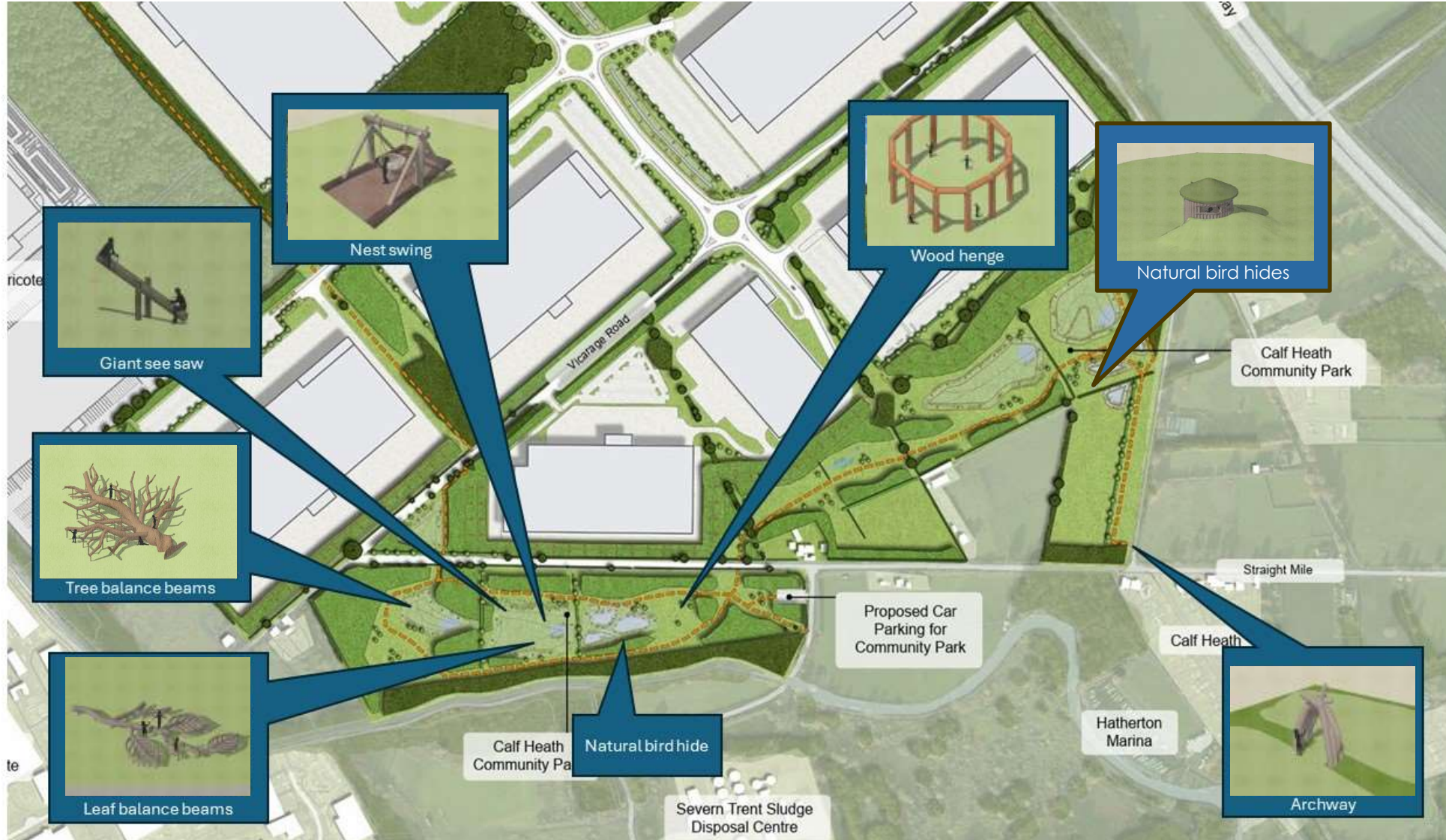

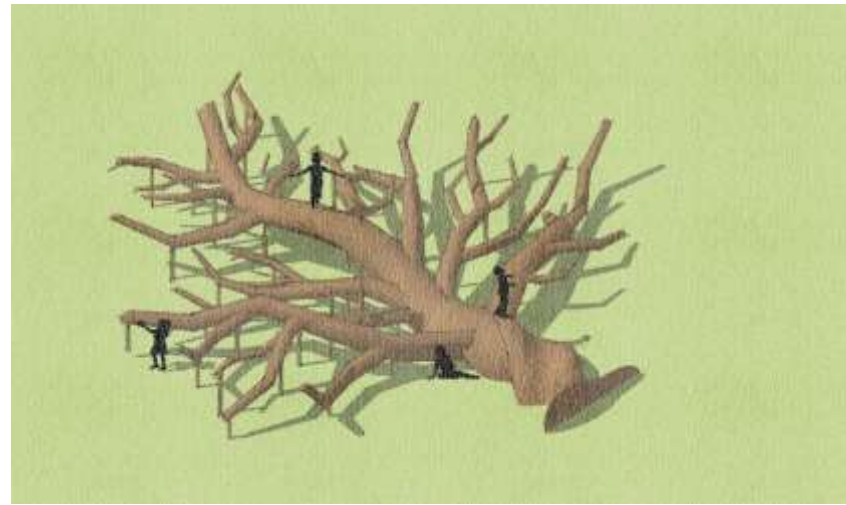
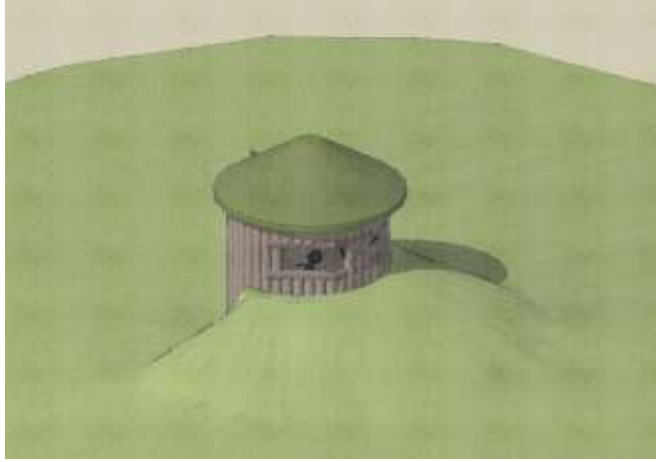

Hand made using natural timber from the site

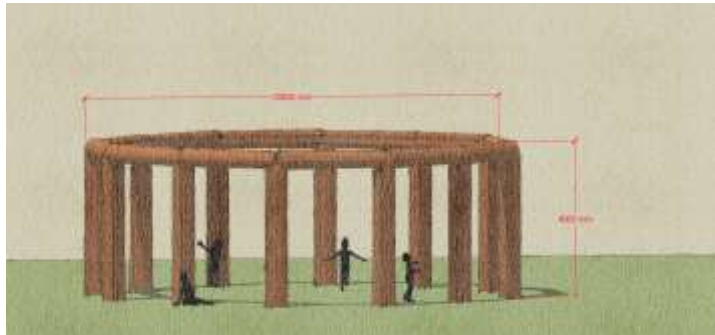



# Design specifications



## Design Specification

A spectacular landscape and wildlife feature enabling visitors to the park to observe nature without disturbing wildlife. The whole feature is almost all natural materials and forms a living habitat.

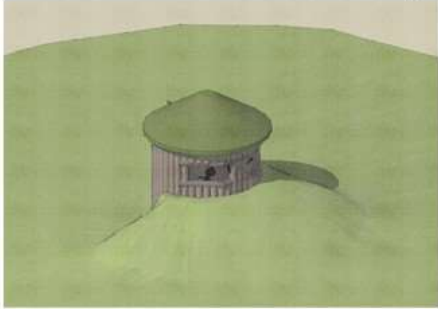

1 ancient tree sized structure handmade and oak limbs.



3 of leaves and twigs. It's pieced together using



ure. The nest swing is a great accessible play



re with accessible play elements.



a Stonehenge using large oak tree stems. A

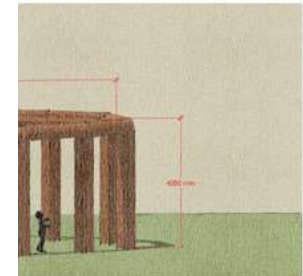

Design name	Naturalistic bird hide
Material	Untreated English Oak, Sawn timber, Wildflower turf, Membrane system for roof, Crushed stone floor
Manufactured elements	Fixings only
Surface requirements	N/a
Age range	Universal
Natural play benefits	Multifunctional, observing wildlife, refuge, relaxing.
Sense of place benefits	Secluded, surrounded by wildlife, landscape integration, Aesthetic.
Inclusive/accessible	Accessible to less able children and adults including elderly visitors, sensory touch, natural textures, smell. Being immersed in nature.

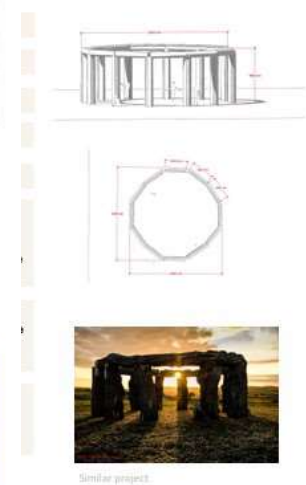
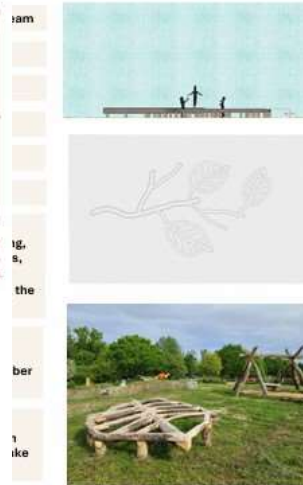
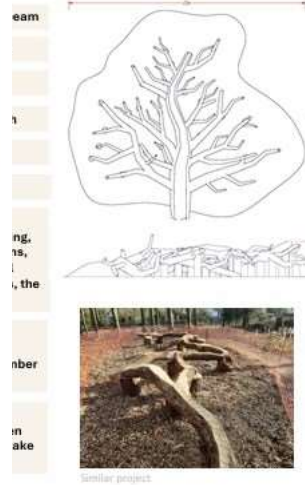
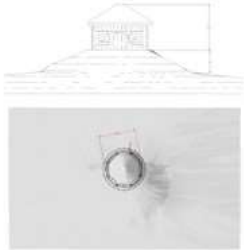
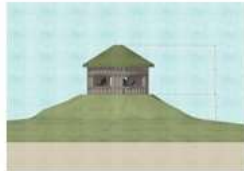

Bird hide concept



# AOB and Next Steps